

SWING /HAMMOCK ASSEMBLY INSTRUCTION

1. Install the swing / hammock only in a place with sufficient free space, i.e. take into consideration the distance from the walls, furniture and other obstacles that may potentially restrict the range of movement of the swing / hammock. Make sure there is enough space to the sides and in front and behind the swing. It is recommended to keep at least 50 cm lateral distance and at least 250 cm distance in front and behind the swing
2. Make sure the swing / hammock is mounted to a sufficiently strong and solid ceiling, i.e. concrete / brick / wood / steel frames, etc. Do not mount to a plasterboard, etc..
3. Mount the swing using two attachment points. The distance between mounting holes cannot be narrower than the width of the seat, i.e. at least 40 cm. 4..
4. A swing / hammock can be mounted using either a closed loop and a snap hook (image 1) or a special swing hook (image 2)



Image 1



Image 2

5. Prepare the fixing holes according to the guidelines indicated by the manufacturer of the fixing system, i.e. dowels/hooks. Drill the holes using the appropriate type and size of drill bit and the recommended hole depth.

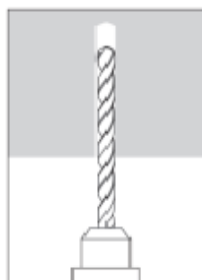

Image 1

6. Fix the elements of the fixing system to the ceiling. Choose an appropriate type of fixing dowels for the material in which they will be installed to. It is recommended to use anchors of min. 12 mm and of min. 100 kg load

capacity. Check stability of the dowel installation.

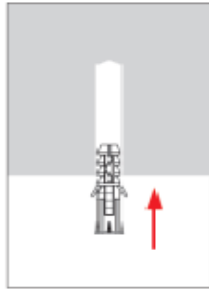

Image 2

7. The following example shows a variant of attachment using swing hooks. Screw the swing hook into the correctly seated dowel.

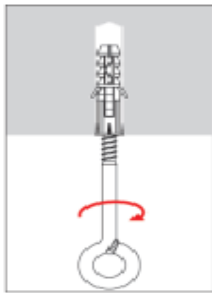

Image 3

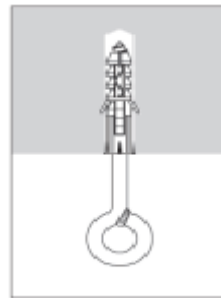

Image 4

8. After the mounting system is ready, proceed with the assembly of the swing / hammock. First attach the mounting ring on the rope - pull it through the folded rope on both sides of the seat



Image 5

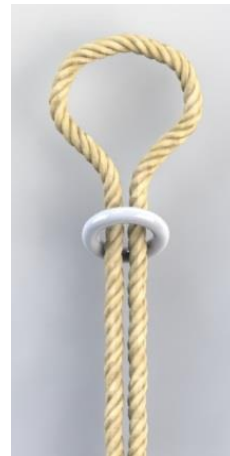

Image 6

9. Make a knot as shown in the picture below. After making the knot, tighten the whole thing firmly on the circle.



Image 7a



Image 9b



Image 9c

10. After tightening the knot on the dowel, put on the previously prepared and properly installed swing hooks. Mount the wheels perpendicularly to the swing hook axis.



Image 8a



Image 10b